

20698-T

DIE NUMBER

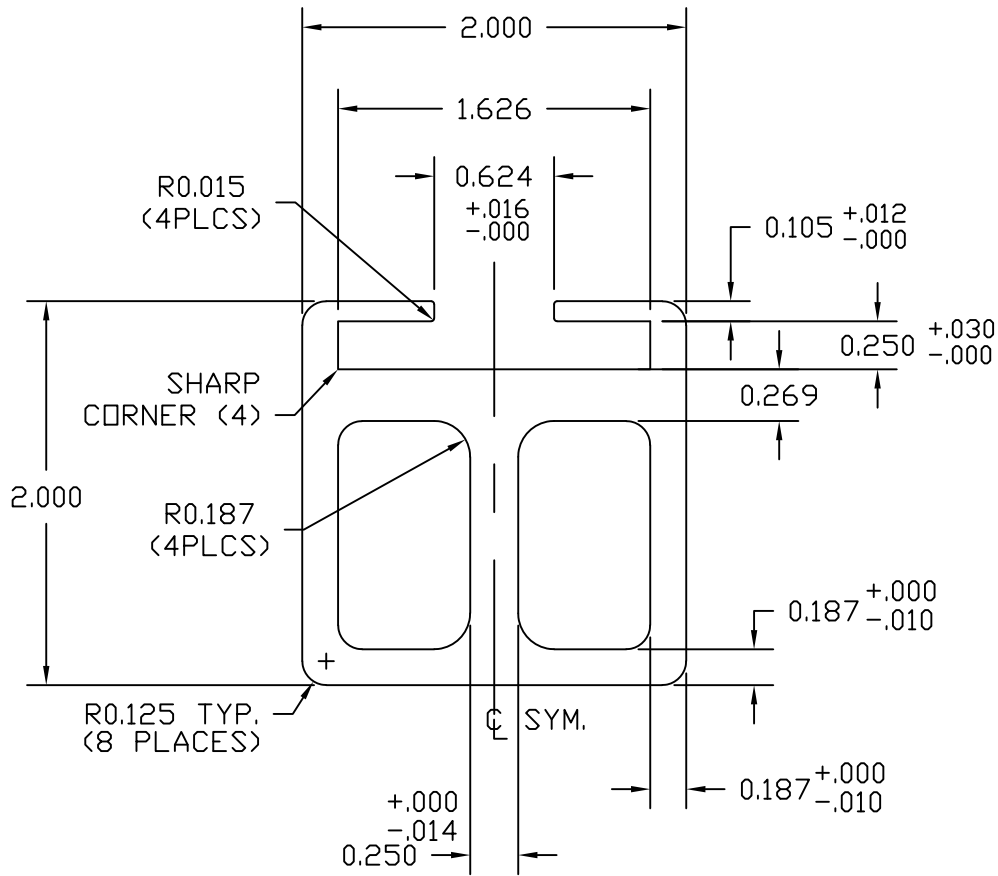

NOTE:
 ALL UNSPECIFIED TOLERANCE ± 0.030

EXTRUDED ALUMINUM CORPORATION IS NOT IN ANY WAY RESPONSIBLE FOR THE DESIGN OR APPLICATION OF THIS PART. THE ALUMINUM ASSOCIATION STANDARD COMMERCIAL TOLERANCES APPLY UNLESS OTHERWISE SHOWN.

REVISIONS



Extruded Aluminum CORPORATION

**7200 Industrial Dr.
 Belding, MI. 48809**

PHONE (616) 794-0300
 FAX (616) 794-0879

DRN. BY SMB		DATE 04/29/96		REVISION LEVEL	
CUSTOMER EXTRUDED ALUMINUM					
PART NO. CMHE5033					
PART NAME ALUMINUM EXTRUSION					
PRESS		BOLSTER	SUB-BOLSTER	SPACER	DIE NUMBER
	1	928			
	5	640	214		
RELEASE #	4	DRAWING/QUOTE NUMBER			TW96-0307

ADDED PRESS 5 TOOLING 12/3/03 DJS			
DRAWING SCALE	FULL	RATIO	33:1
EST. AREA	1.922	DIE SIZE	10 X 6
EST. WEIGHT	2.306	NO. HOLES	1
OUTER PERIM.	10.474	BACKER NO.	
INNER PERIM.	6.972	FEEDER NO.	
CIRCUM. C.	2.725	VENDOR	THUMB